



ASYMMETRICAL POLYAMIDE HINGES WITH CARBON FIBER

54-1-3562

Hinges are made of 30% carbon fiber 6.6 PA.
Pin: 303 stainless steel.

A	120 mm
Material	polyamide

Weight (g)	168 g
B	180 mm
C	8 mm
E (knuckle or thickness)	9.3 mm
D (pin diameter)	8
F (pitch)	55 mm
G (pitch)	90 mm
H (height or starting holes)	77.5 mm
Finish	black
J	17.5 mm
Nouvelle référence	NEW

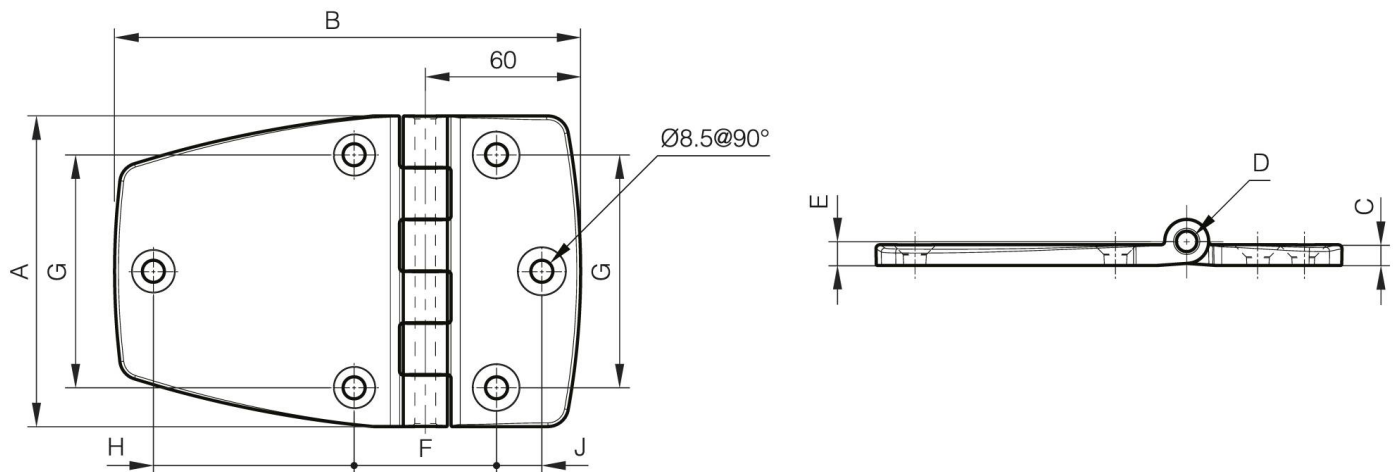

K	60 mm
----------	-------