



## **ASYMMETRICAL POLYAMIDE HINGES WITH CARBON FIBER**

**54-1-3556**

Hinges are made of 30% carbon fiber 6.6 PA.  
Pin: 303 stainless steel.

<b>A</b>	80 mm
<b>Material</b>	polyamide

<b>Weight (g)</b>	100 g
<b>B</b>	120 mm
<b>C</b>	7.8 mm
<b>E (knuckle or thickness)</b>	8.25 mm
<b>D (pin diameter)</b>	7
<b>F (pitch)</b>	50 mm
<b>G (pitch)</b>	55 mm
<b>H (height or starting holes)</b>	40 mm
<b>Finish</b>	black
<b>Nouvelle référence</b>	NS

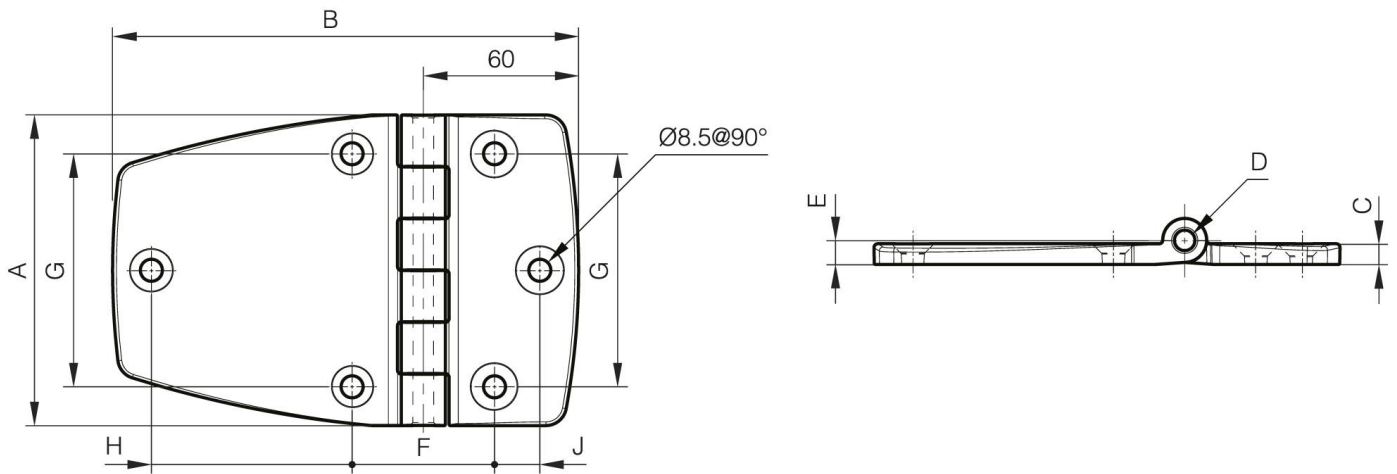

<b>K</b>	40 mm
----------	-------