



STAINLESS STEEL DUAL BALL CATCHES

16-7-4306

Catch force is not adjustable. Do not turn the slot part.

A	50 mm
Material	316 stainless steel
Weight (g)	30 g

B	10 mm
C	16.1 mm
S (hole diameter)	4.2 mm
E (knuckle or thickness)	2.9 mm
D (pin diameter)	31.5
F (pitch)	40 mm
G (pitch)	20 mm
H (height or starting holes)	30 mm
Finish	polished
J	9 mm
L	2.9 mm
C1	12.2 mm
C2	7.7 mm

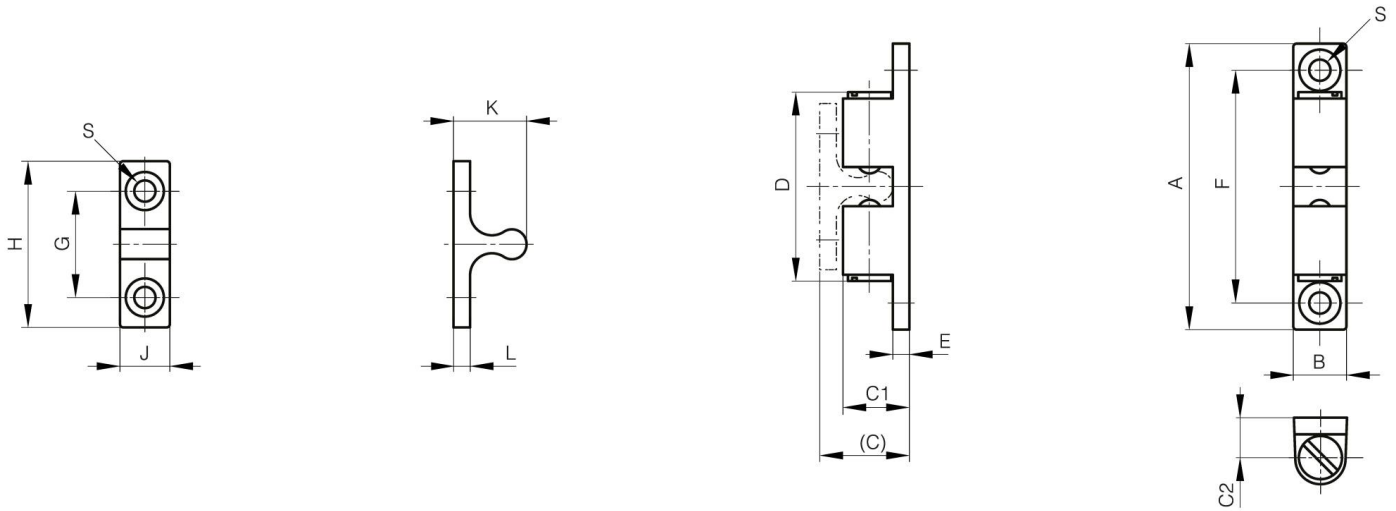

K	13.2 mm
----------	---------