



STAINLESS STEEL DUAL BALL CATCHES

16-7-4305

Catch force is not adjustable. Do not turn the slot part.

A	43 mm
Material	316 stainless steel
Weight (g)	18 g

B	8 mm
C	13.5 mm
S (hole diameter)	3.2 mm
E (knuckle or thickness)	2.5 mm
D (pin diameter)	28.4
F (pitch)	35 mm
G (pitch)	16 mm
H (height or starting holes)	25 mm
Finish	polished
J	7.5 mm
L	2.5 mm
C1	10 mm
C2	6 mm

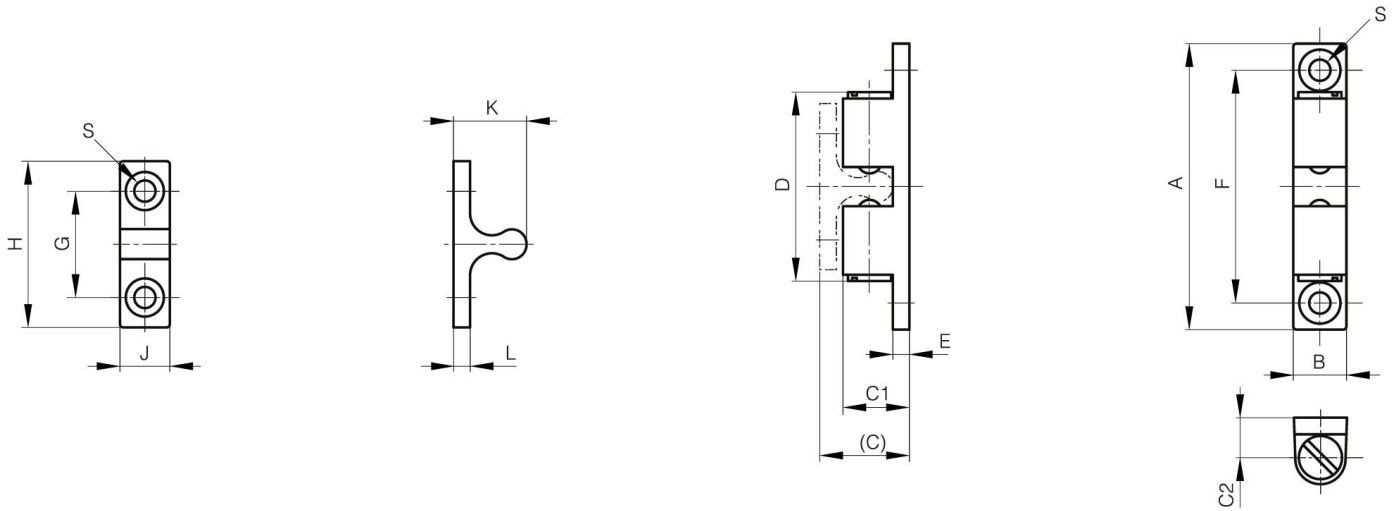

K	11 mm
----------	-------