



## DUAL BALL CATCHES B

16-7-3423

Strike can be secured on 2 sides of the catch.

Body of the catch: zinc die-cast with brass finish.

Balls: in steel

Strike: in steel with brass finish.

<b>A</b>	41.7 mm
<b>Material</b>	zinc die-cast

<b>Weight (g)</b>	14 g
<b>B</b>	8.5 mm
<b>C</b>	10.7 mm
<b>E (knuckle or thickness)</b>	2.6 mm
<b>D (pin diameter)</b>	26
<b>F (pitch)</b>	34 mm
<b>G (pitch)</b>	16.9 mm
<b>H (height or starting holes)</b>	25.7 mm
<b>Finish</b>	brass
<b>J</b>	8 mm
<b>L</b>	1.2 mm

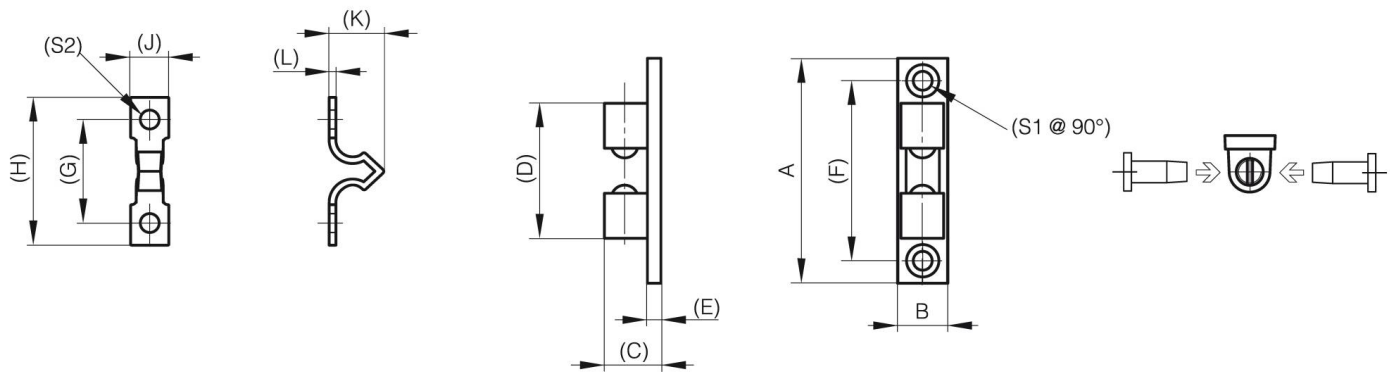

<b>K</b>	13.5 mm
----------	---------