



## **FLAG HINGE WITH WASHER - 62 X 62 MM**

**12-1-3635**

Flag hinge with brass washer.

<b>A</b>	62 mm
<b>Note</b>	type 1
<b>Material</b>	steel

<b>Weight (g)</b>	87 g
<b>B</b>	62 mm
<b>C</b>	2.5 mm
<b>E (knuckle or thickness)</b>	30 mm
<b>D (pin diameter)</b>	7
<b>Finish</b>	raw

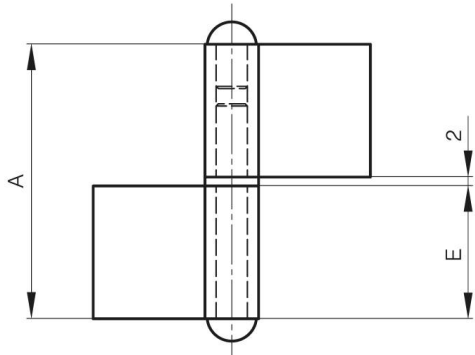

12-1-3635

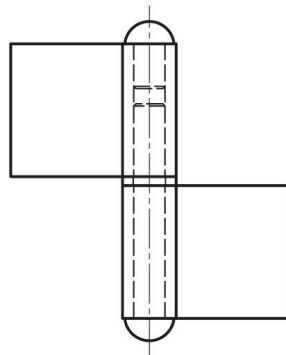

12-1-3634

