



## **EXPANDED PIN BG FOR MODULO SYSTEM**

**27-1-3822**

This pin alone enables you to make a hinge pin for Modulo hinges.

|                         |       |
|-------------------------|-------|
| <b>Material</b>         | steel |
| <b>Weight (g)</b>       | 74 g  |
| <b>D (pin diameter)</b> | 10    |

|               |             |
|---------------|-------------|
| <b>Finish</b> | zinc plated |
| <b>L</b>      | 120 mm      |

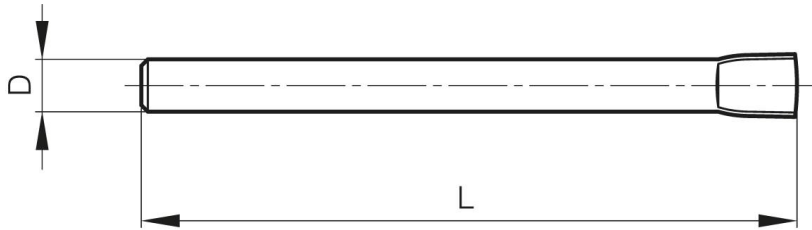

BG Broche Gonflée  
Expanded pin  
Gestauchter Stift